



# my fathers heart

Handmade in Sheffield with passion.

Apartments 1-3  
Botanical House  
46 Rutland Park Road  
S10 2PB

# Furniture: SieMatic



front color edge on three sides



64110 lotus white matt

Carcase edge: 7670 aluminum colored

Safety profile color: dark grey



64111 sterling grey matt

Carcase edge: 7670 aluminum colored

Safety profile color: dark grey



373 crick



375 grey braganza granite

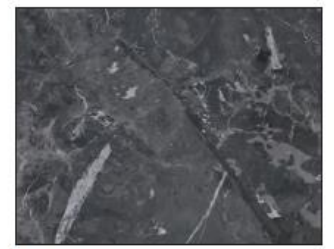

374 marmo nero



64112 graphite grey matt

Carcase edge: 7670 aluminum colored

Safety profile color: dark grey



64113 java oak

Carcase edge: 7670 aluminum colored

Safety profile color: dark grey



64114 onyx oak

Carcase edge: 7670 aluminum colored

Safety profile color: dark grey



371 java oak (SieMatic color)



372 onyx oak (SieMatic color)

Laminate splashback & breakfast bar finishes

Colors for recess channel profiles, grip profiles and grip slots

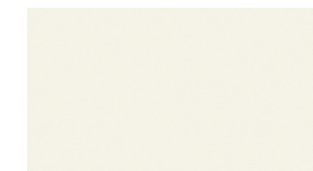

lotus white



sterling grey



graphite grey



black



stainless steel color inox

Metal channel rail/grip slot colours

SieMatic SLC handleless furniture with metal trim profiled doors in laminate matt finish with laser bonded edges



Worktops:



Gris Expo  
Mythology Series



Marengo  
Basiq Series

N-BOOST



Rougui  
Basiq Series

20mm Silestone Quartz polished worktops (choice of 3 colours) in all apartments, with 25 year warranty as standard

Botanical House



my fathers heart

chrissi@myfathersheart.com  
+44 (0)114 2 500 177  
www.myfathersheart.com



# Apartments 1-3

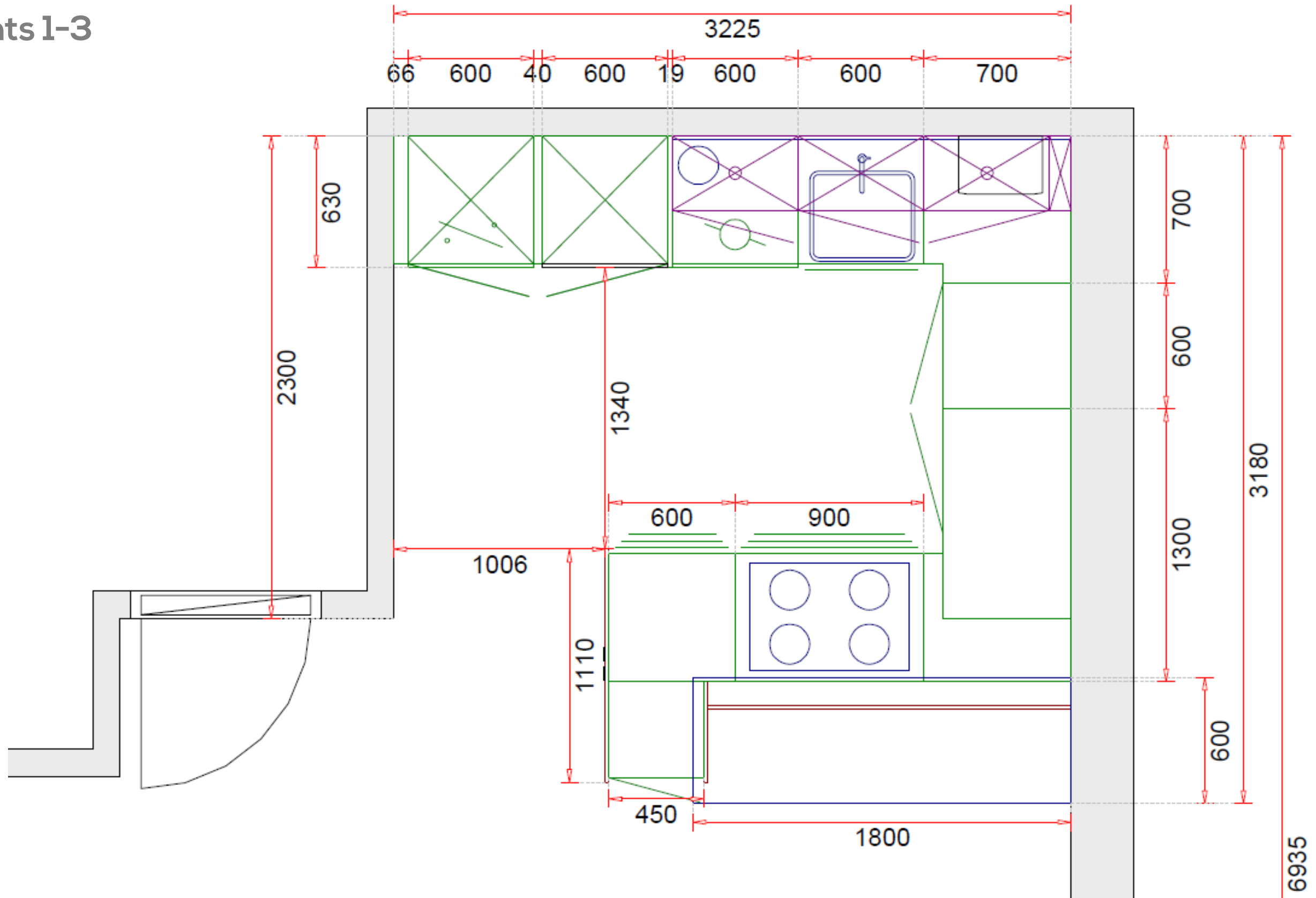

Botanical House



my fathers heart

chrissi@myfathersheart.com  
+44 (0)114 2 500 177  
www.myfathersheart.com

# Apartments 1-3



Botanical House



my fathers heart

chrissi@myfathersheart.com  
+44 (0)114 2 500 177  
www.myfathersheart.com



Botanical House



my fathers heart

chrissi@myfathersheart.com  
+44 (0)114 2 500 177  
www.myfathersheart.com

# Apartments 1-3



Botanical House



my fathers heart

chrissi@myfathersheart.com  
+44 (0)114 2 500 177  
www.myfathersheart.com



# Apartments 1-3



Botanical House



my fathers heart

chrissi@myfathersheart.com  
+44 (0)114 2 500 177  
www.myfathersheart.com

# Apartments 1-3

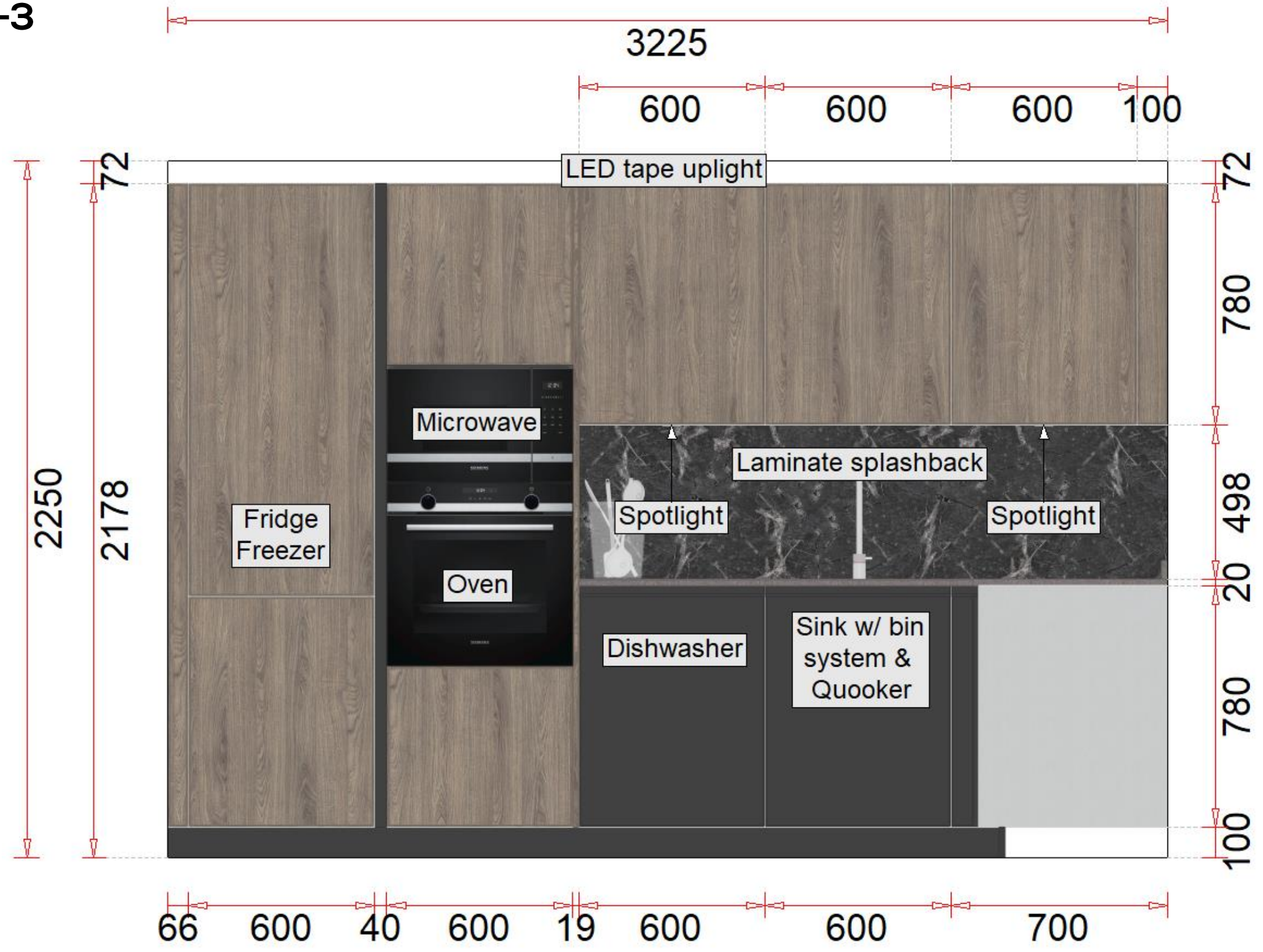

Botanical House



my fathers heart

chrissi@myfathersheart.com  
+44 (0)114 2 500 177  
www.myfathersheart.com

# Apartments 1-3

Botanical House

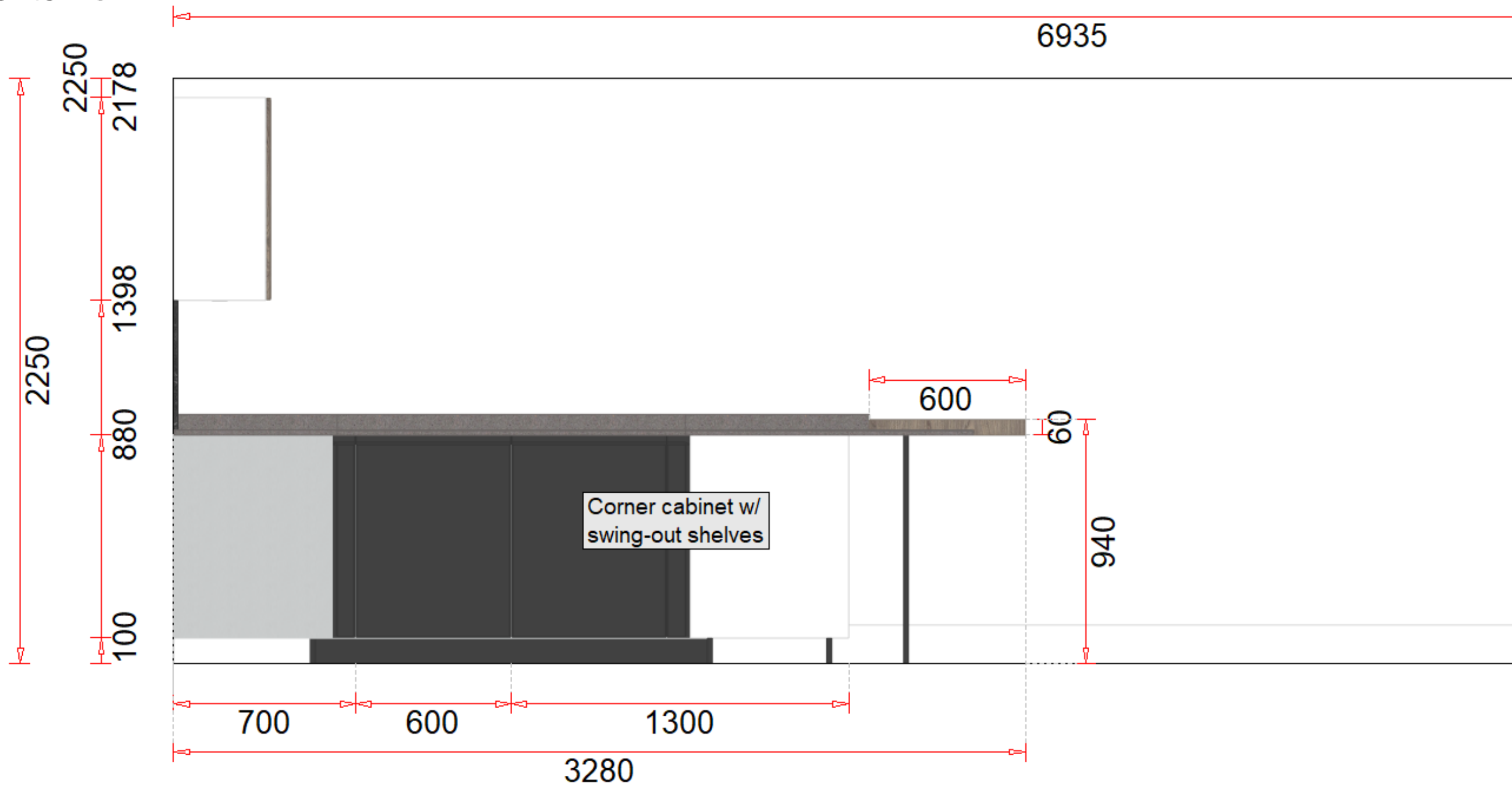

my fathers heart

chrissi@myfathersheart.com  
+44 (0)114 2 500 177  
www.myfathersheart.com





# Appliances: **SIEMENS**

Botanical House



**HB535A0SOB**

iQ500 Single oven with 5 heating methods

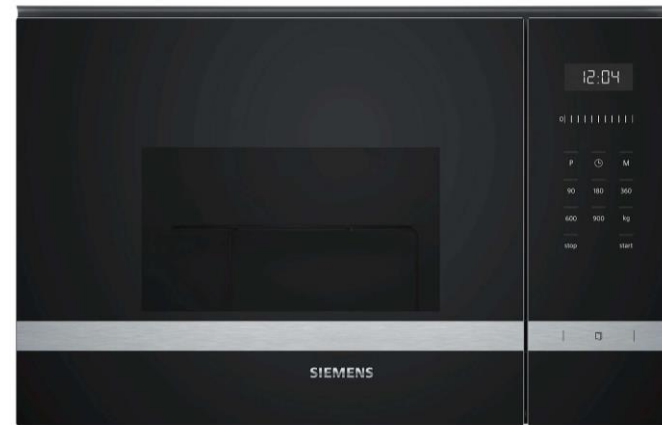

**BF555LMSOB**

iQ500 Built-in microwave with 900 watt power



**SN636X00KG**

iQ300 Fully-integrated 60cm dishwasher with 13 place settings

**KI87VVF30G**

iQ300 Integrated 70/30 split fridge freezer

Net fridge: 209 litres

Net freezer: 63 litres



my fathers heart

chrissi@myfathersheart.com  
+44 (0)114 2 500 177  
www.myfathersheart.com

# Appliances: BORA



## BORA BIU

Compact, flexible and powerful – BORA Basic combines an extractor, induction cooktop and recirculating filter in one. The compact system can be installed in any kitchen in a matter of minutes.

BORA technology draws off odours and grease particles directly from the cookware. This prevents cooking vapours from rising up and spreading throughout the room. Grease particles are trapped in the stainless steel grease filter – like cooking in fresh air





my  
fathers  
heart

My Fathers Heart Ltd

Unit 3a

Broadfield Court

S8 0XF

01142 500 177

